



Molly&Cody

Pet Grooming Kit



Molly&Cody

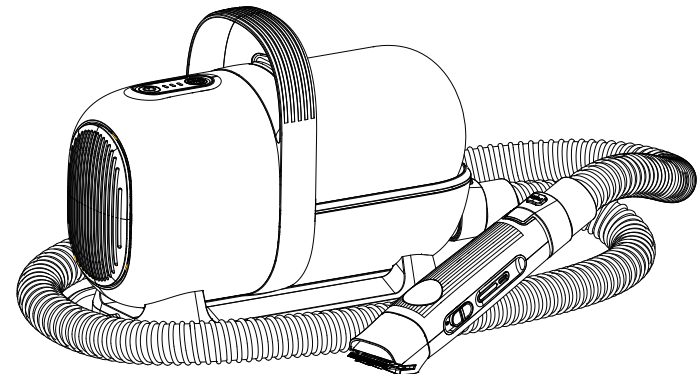

User Guide

Modell: LM7

Contents

Safety Information	1
Cautions	2
Package List	3
Vacuum Device	4
Installation	4-5
Wireless Clipper	6
Use of Accessories	7-9
Care and Maintenance	10-12
Specifications	12
Trouble Shooting	13
Q&A	14
Warm Tips	14
Warranty	15

Safety Information

- This product is only for household use, not for commercial or industrial use: not for outdoor or humid places.
- Never use this product alone for children or people with weak thinking ability.
- When using it, please use it in an environment where it can be used safely and under the instructions and supervision of a person who understands the safe use of the product and its hazards. Under such circumstances, please never let children use it.
- Please pay full attention when using it near children and pets. In addition, please be careful not to let children and pets play with this product;
- Please do not touch the power plug and this product with wet hands, please do not absorb moisture and liquid;
- Please do not use this product when the power cord or power plug is damaged. In the case of this product not working normally, in the case of damage, placed outdoors or immersed in liquid, please be sure to contact our company;
- Please do not disassemble the product, wrong assembly method may cause electric shock or fire, please contact our company when you need repair;
- Please do not inhale flammable or combustible liquids such as gasoline. In addition, please do not use it in an environment with flammable or combustible gas or nearby;
- Do not pull the power cord, do not put heavy objects on the top of the machine and do not clamp the wires to close the door;
- Please do not smoke anything that is on fire, smoking or high temperature such as cigarettes, matches, hot soot;
- Please do not put anything into the opening or block the opening for use; After use, please pull out the plug from the socket before maintenance or parts replacement;
- Please do not use or keep it in humid places such as outdoors or in the bathroom or where a glass of water is wet;
- Please do not use products with fragrances and fragrances as filters. Such chemicals may become one of the causes of fire.

Cautions

- **Please do not operate or unplug the power cord with wet hands.**
In order to avoid malfunction and electric shock, please absolutely prohibit
- **Please do not use in places with smoke and other flammable things**
Because it may cause fire and explosion, please do not inhale highly flammable liquids and combustibles.
- **There may be a peculiar smell when used for the first time, but it will not cause adverse effects on the body.**
When using this product for the first time, there will be an odor but it will disappear after a while. Please understand. However, if the burnt smell persists, please stop using it immediately!
- **Please keep the dust cup and filter clean for a long time.**
If the dust cup and filter are dirty, they cause malfunction, and unexpected accidents.
- **When maintaining, be sure to cut off the power and unplug the power cord before proceeding**
If the power is turned on for maintenance, there will be a risk of electric shock accidents and injuries.
- **This product stops its operation when the temperature rises abnormally**
If abnormal heating of the motor occurs, or if the suction port is blocked, the operation will stop immediately. Take out the dust cup, confirm that the suction port and filter are clean, and then turn on 60 minutes later.
- **Be sure to use each filter with the installed state**
Please be sure to install and use the filter, If the filter is removed and used, it will be one of the reasons for the failure.

Package List

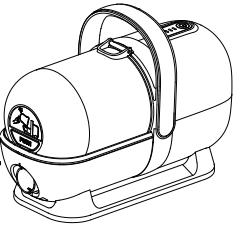

Vacuum Device



Storage Tray



Sponge

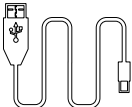

Typ-C-Kabel



Grooming Brush

01



Deshedding Tool

02

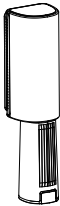

Cleaning Brush

03



Nozzle

04



Electric Wireless Clipper

05



Clipper Blade

06



Pet Paw Trimmer

07



Pet Nail Grinder

08



3 mm (1/10 ")



6 mm (1/4 ")



9 mm (1/3 ")



12 mm (1/2 ")



18 mm (3/4 ")



23 mm (4/4 ")

09

3

Vacuum Device

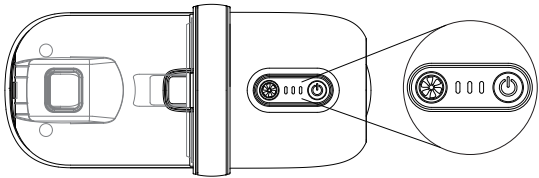

Gear Shift Button



Mode Indicator Light



On/off Button

Warning: inbuilt with voltage error protection setting. If the input voltage is wrong. The indicator on the panel will flash along with a "beep" sound when pressing the button.

Installation

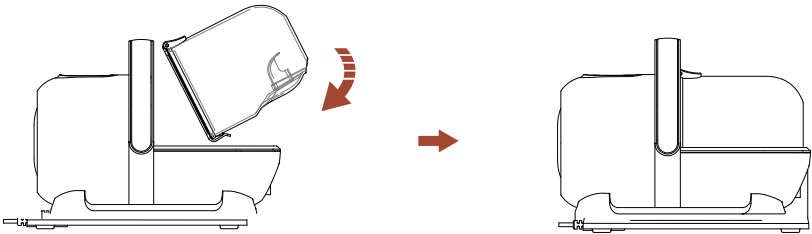

Put the dust cup gently along the direction of the arrow

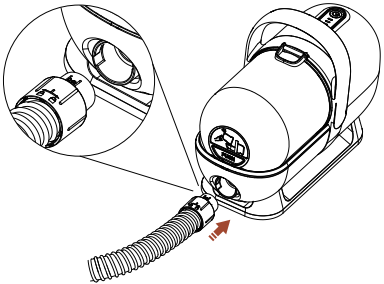

Rotate to lock it

4

Installation

Accessory Installation

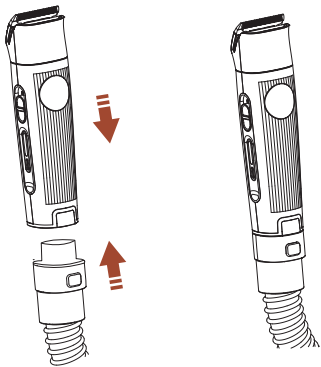

Insert to install

Accessory Replacement

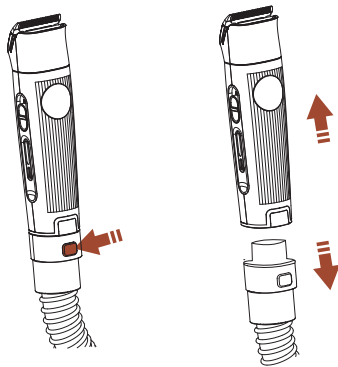

Press the button to unplug the hose

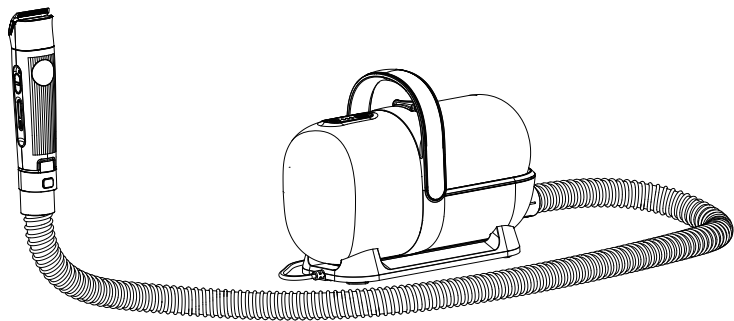

Complete Installation

Wireless Clipper

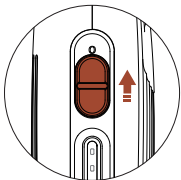
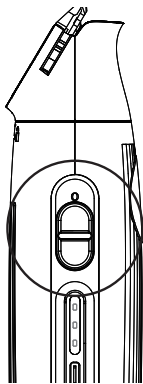

Turn on
Slide up

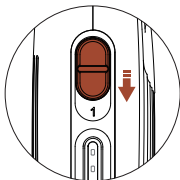

Turn off
Slide down

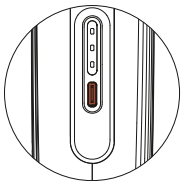
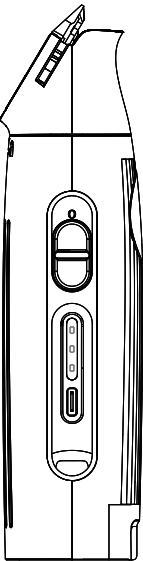

Type C
Charging

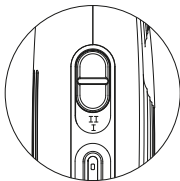

2 Modes
Adjustal

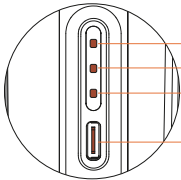

70%-100%
40%-69%
0%-39%
TYPE-C

Clipping Comb
Choose different sized comb according to your pet's hairstyle

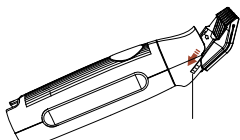
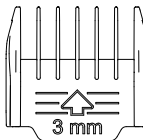

Install the comb along the track

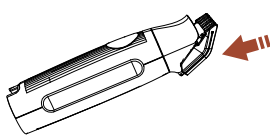

Get it installed

Use of Accessories

Connection A

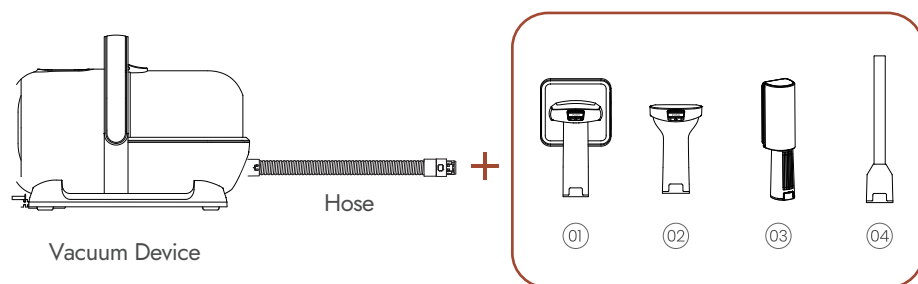

01

Grooming Brush

Clean the floating hair and dust on the fur; enghen the hair to make the hair more fluffy

Push the button down

hair be sucked in

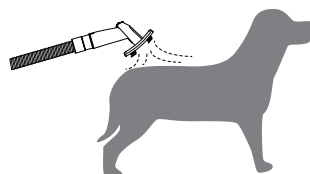
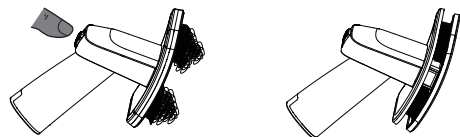

02

Deshedding Tool

Quickly remove loose hair.

Note: Please pay attention to the sharp position of the cutting edge, to avoid skin scratches caused by excessive force.

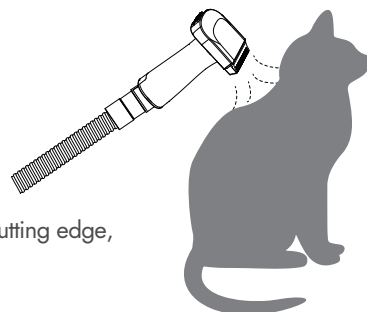

Use of Accessories

03

Cleaning Brush

Clean fallen hair on clothes, sofas, and carpets.

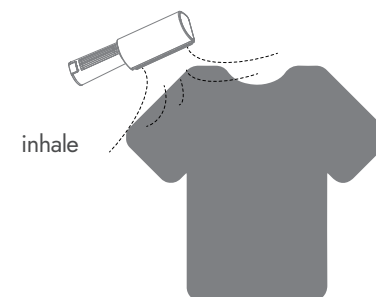

04

Nozzle

Suck hair falling between seams of sofas, and carpets.

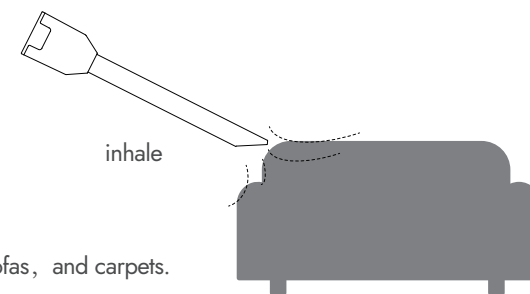

Connection B

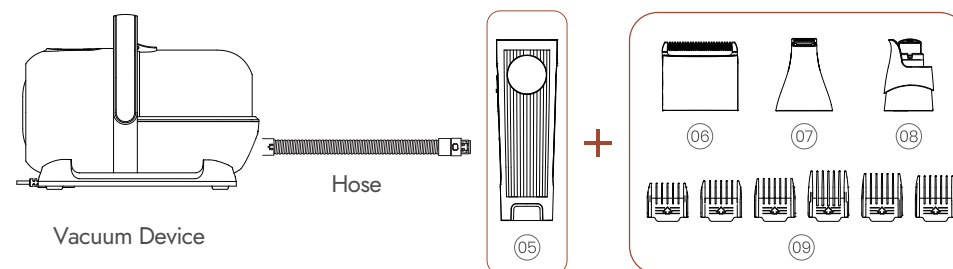

Use of Accessories

06

Electric Wireless Clipper

Shave your pet's hair and suck into the dust cup to prevent hair from falling elsewhere.

Note:

Please be careful with pets' skin avoiding skin scratches caused by excessive force.

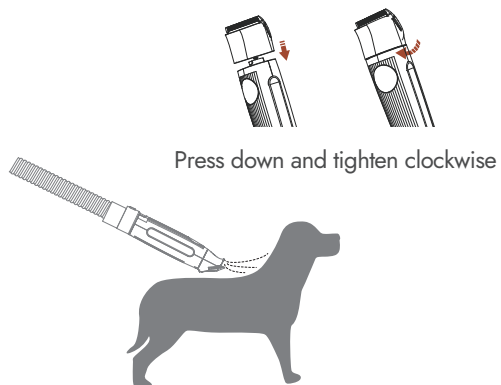

07

Pet Paw Trimmer

Trim the hair of pets' paws and other details.

Note:

Please pay attention to the sharp position of the cutting edge, to avoid skin scratches caused by excessive force.

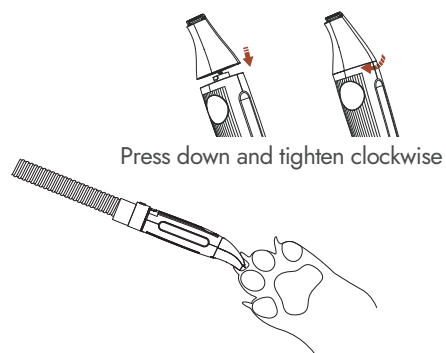

08

Pet Nail Grinder

Polish your pet's nails to round the nails

Note:

Please be careful with the soft parts of the pet's skin, avoiding skin scratches caused by excessive force

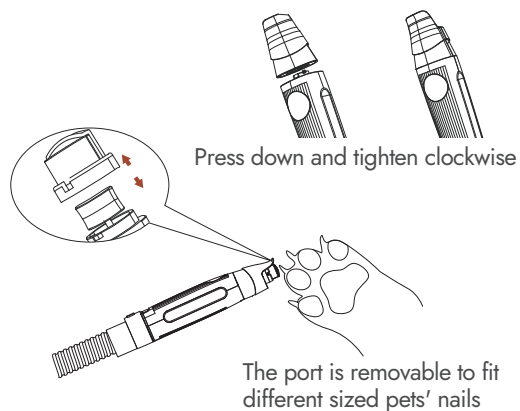

Care and Maintenance

Clean the Dust Cup

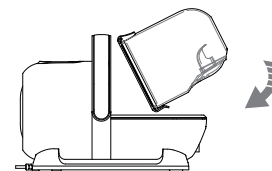
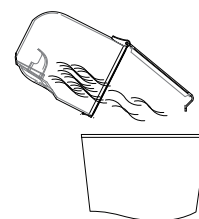
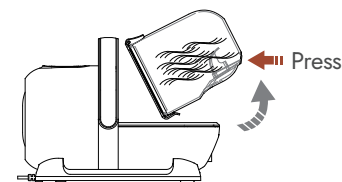

Clean the Electric Clippers

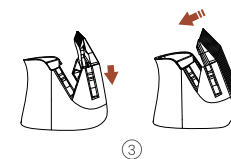

Care and Maintenance

Change the HEPA Filter Every 6 Months

Remove the dust cup, take out the HEPA

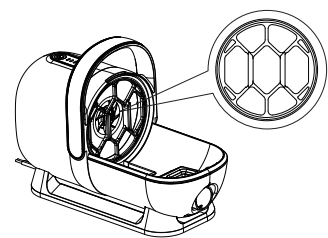

Note: Please use original filter

Clean the Sponge Filter

① Remove the dust cup and takeout the sponge.

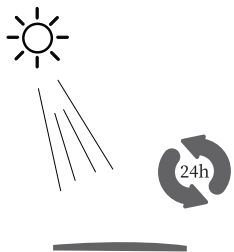
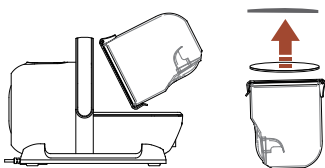

③ Place it in a well-ventilated placefor at least 24 hours of drying.

② Please wash with tap water. and drain the water after washing

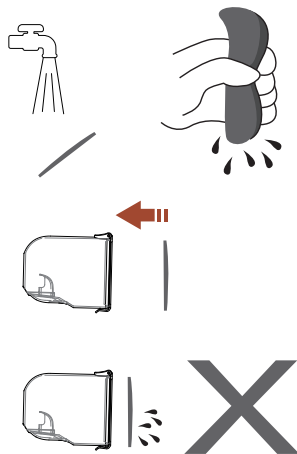

④ Install the sponge back to the origina- place after it is complete dryBe sure to install the sponge

Care and Maintenance

Note:

- The filter should be cleaned with cold water at least every other month.
- The maintenance period is different on the basis of the use frequency and condition. Clean the sponge when it gets dirty
- When cleaning, please disconnect the power supply and unplug the plug from the socket.
- Be sure to install sponge filter after drying. Wet sponge filter will cause electric shock and malfunction.

Spezifikationen

Input	EU 220-240V-50Hz US 110-130V-60Hz UK 220-240V-50Hz
Power	300W
Hose Length	4.9FT
Dust Cup Capacity	1.5L
Product Size	11.7*8.7*5.5IN
Wire Length	8.7FT
N.w.	6.68LB
Maximum Noise	75dB

Input	DC 5V 1A
Power	5W
Charge time	3h
Discharge time	2.5h
li-ion battery	3.7V 18500 1400mAh

Troubleshooting

Please stop using the product immediately if any abnormal situation occurs in the using process. Refer to the following FAO to troubleshoot.

Please do not disassemble the machine to maintain by yourself.

Issue	Troubleshooting	Solution
Can't be powered on	The plug is not inserted properly Switch of the machine is not turned on	Replug it in place Press the switch button to turn it on
Weak suction	The flexible hose is clogged Dust cup is full Filter is clogged	Clean the hose and suction mouth Empty the dust cup Clean the filter
The clipper is not smooth	The head of clipper is clogged The blade is not lubricated enough	Remove excess hair from the blade Drip lubricating oil
Abnormal noise after a period of use	The head of clipper is clogged The blade is not lubricated enough	Remove excess hair from the blade Drip lubricating oil
Automatically shuts down shortly after startup	The head of clipper is clogged The blade is not lubricated enough	Remove excess hair from the blade Drip lubricating oil
Device heats up	Continuously use too long Don't worry too much about it	Keep off for 20 minutes before restarting. Overheating protection program setted
Blade dislodged/loose	Didn't installed in place	Change the blade

Q&A

Question	Answer
How long are the wire and hose?	The wire is 8.7ft long, and the hose is 4.9ft.
Can the wireless clipper be used alone?	Yes, the clipper is inbuilt with rechargeable lithium battery.
How to clean the clipper?	Please refer to the 8th page of the manual.
How long does the battery last?	The clipper can last 2 hours after fully charged.
Can the hose be replaced?	Yes, the hose is detachable, and we sell hoses separately.
Can the blades be replaced?	Yes, the blade is detachable, and we sell blades separately.
Is there a blade to trim the hair of the claws?	Yes, it comes with a "Pet Paw Trimmer" to do it.
In addition to sucking hair, can this device suck anything else?	Yes, it can be used as a vacuum to clean sofa, bed
Are the accessories of the groomer compatible with other brands?	No, but we provide exclusive accessories.
How about the noise? Will it scare my pet?	The working sound is 65db, won't scare pets.
Can the HEPA be replaced?	Yes, it is suggested to be replaced every 6 months and we sell HEPA separately.

Warm Tips

To make your pet even more enjoyable in grooming, you may follow these tips:

1. Turn on the machine for a while before using to let your pet get used to the working noise.
2. Keep the machine away from pets as much as possible, in order to minimize noise scare.

Warranty

1. The warranty period is 12 months from the date of purchase. The warranty is only limited to free repair of the product purchased. Consumables and accessories are not subject to warranty
2. If it is damaged or malfunctioned during normal use, it will be repaired free of charge within the warranty period if it cannot be repaired, a replacement will be provided
3. The following conditions are paid repairs even during the warranty period.
 - (a) Failure and damage caused by misuse or carelessness;
 - (b) Damage due to shipping;
 - (c) Damage caused by pets (scratches, bites, touching the body or riding products);
 - (d) Failure and damage caused by fire, earthquake, and other natural disasters;
 - (e) Failure and damage during use other than general household use (long-term use for business, etc.);
4. In the following situations, no repairs will be provided regardless of the warranty period:
 - (a) Products not purchased directly from our sales channels (e.g. person-to-person sales, Auctions, etc.);
 - (b) The customer opens the product or tries to reform it;
 - (c) Consumables and accessories.
5. Shipping cost will be borne or reimbursed when the product is covered by warranty service. However, cost of packaging materials will not be covered
6. 6, if it is not covered by the warranty, shipping cost and repair fees will be charged when returning.
7. The warranty period for the exchange product is subject to the warranty period before the exchange (counted from the original purchase date):
8. Repair or replacement is only valid in certain countries
9. Please contact customer service of purchase channel for guidance if you have a question or need to repair.
10. Regulations may be changed without notice. All repairs and requests will be handled according to the most updated warranty.

Certifications

European Union Compliance Statement Battery recycling information for the European Union



Batteries or packaging for batteries are labeled in accordance with European Directive 2006/66/EC and amendment 2013/56/EU concerning batteries and accumulators and waste batteries and accumulators. The Directive determines the framework for the return and recycling of used batteries and accumulators as applicable throughout the European Union. This label is applied to various batteries to indicate that the battery is not to be thrown away, but rather reclaimed upon end of life per this Directive.

In accordance with the European Directive 2006/66/EC and amendment 2013/56/EU, batteries and accumulators are labeled to indicate that they are to be collected separately and recycled at end of life. The label on the battery may include a chemical symbol for the metal concerned in the battery (Pb for lead, Hg for mercury, and Cd for cadmium).

Users of batteries and accumulators must not dispose of batteries and accumulators as unsorted municipal waste, but use the collection framework available to customers for the return, recycling, and treatment of batteries and accumulators. Customer participation is important to minimize any potential effects of batteries and accumulators on the environment and human health due to the potential presence of hazardous substances.

Before placing electrical and electronic equipment (EEE) in the waste collection stream or in waste collection facilities, the end user of equipment containing batteries and/or accumulators must remove those batteries and accumulators for separate collection.

Waste Electrical and Electronic Equipment (WEEE) Directive



All products bearing this symbol are waste electrical and electronic equipment (WEEE as in Directive 2012/19/EU) which should not be mixed with unsorted household waste. Instead, you should protect human health and the environment by handing over your waste equipment to a designated collection

Certifications

point for the recycling of waste electrical and electronic equipment, appointed by the government or local authorities. Correct disposal and recycling will help prevent potential negative consequences to the environment and human health. Please contact the installer or local authorities for more information about the location as well as terms and conditions of such collection points

Restriction of Hazardous Substances Directive (RoHS)

Beijing Junqi Technology Co., Ltd product, with Included parts (cables, cords, and so on) meets the requirements of Directive 2011/65/EU on the restriction of the use of certain hazardous substances in electrical and electronic equipment ("RoHS recast" or "RoHS 2")

Radio and Telecommunications Terminal Equipment Directive



We, Beijing Junqi Technology Co., Ltd, hereby declare that this device corresponds to the basic requirements and relevant regulations outlined in guidelines 2014/53/EU, 2011/65/EU, 2014/30/EU, 2014/35/EU and 2009/125/EC.



Disposal

This symbol on the product or in the instructions means that your electrical and electronic equipment should be disposed at the end of life separately from your household waste. There are separate collection systems for recycling in the EU. For more information, please contact the local authority or your retailer where you purchased the product.